

- 1) MOURAÇÃO DE CONCRETO PÉTO, SEÇÃO  
MÍNIMA: 10 X 10\* CM, H= 3,00 M

CERCA PALITO  
ESCALA 1:50  
FOTOS RM CM

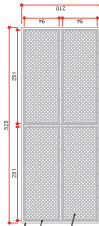

DET. FOLHA PORTÃO VEÍCULO

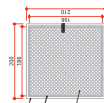

DET. FOLHA PORTÃO PEDESTRE

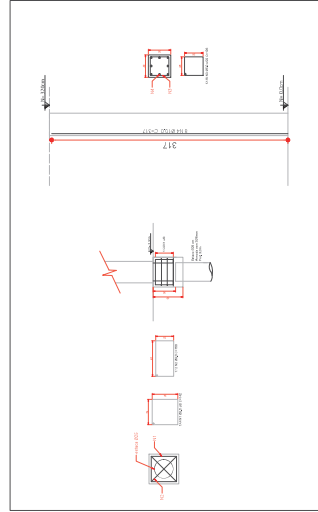

DET. ESTRUTURA SUPORTE PORTÕES

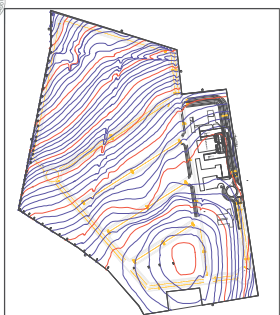
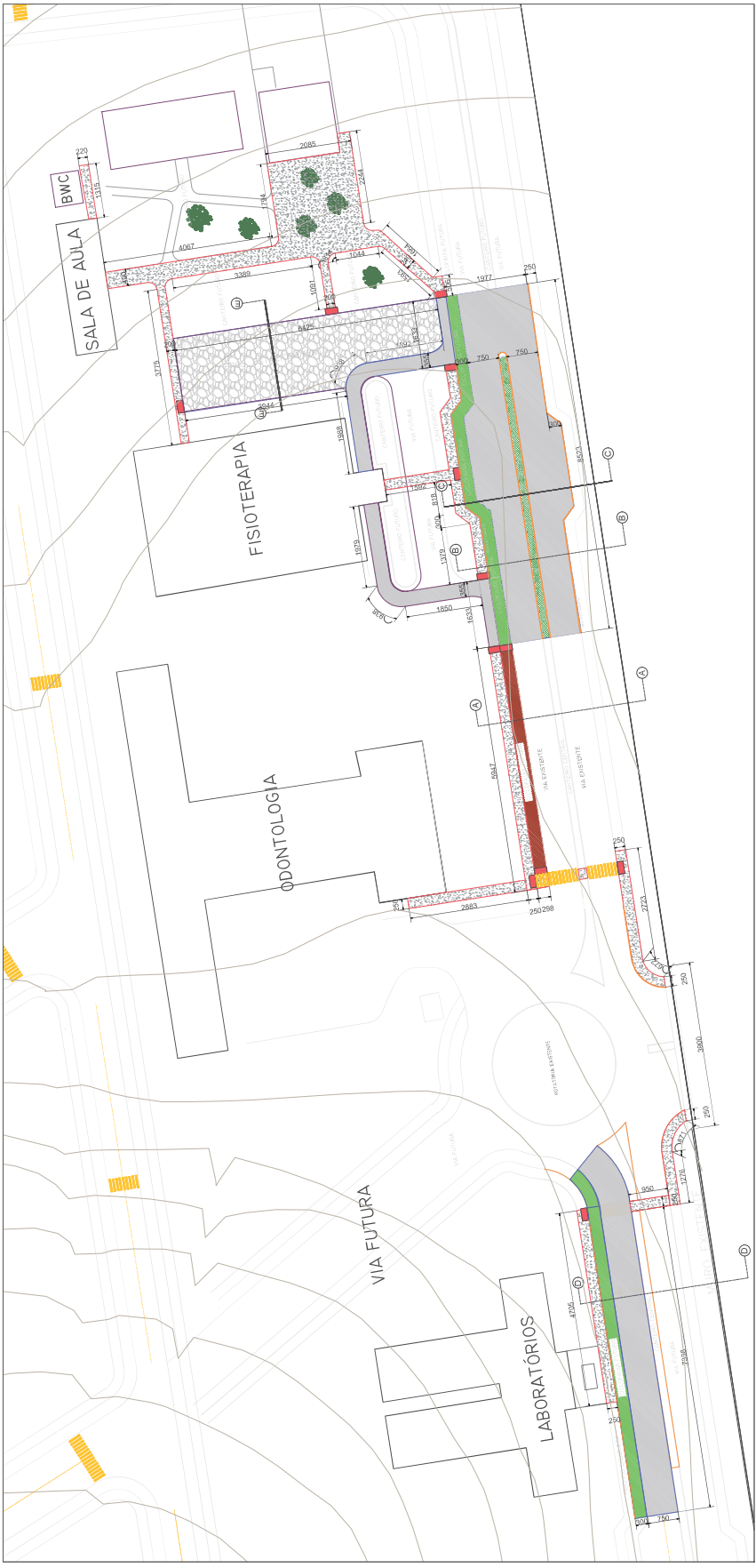

TOPOGRAFIA DO CAMPUS

- CICLOFAIXA À ASFALTAR
- ASFALTO
- CASCALHO + BRITA
- CALÇADA EM CONCRETO
- CICLOFAIXA FUTURA
- REBAIXO CALÇADA
- GUIA (MEIO-FIO)
- GUIA (MEIO-FIO + SARJETA)

PROJETO DE ACESSOS

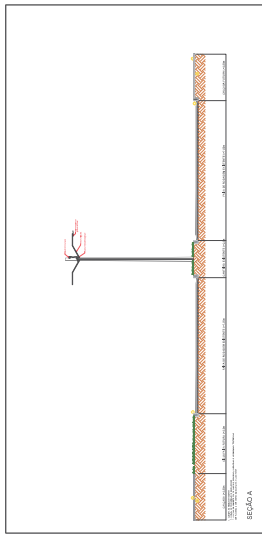

CORTE A - DET. VIA

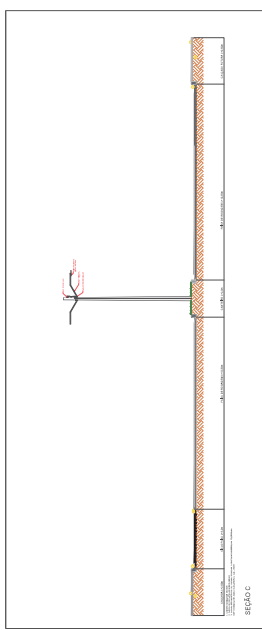

CORTE C - DET. VIA

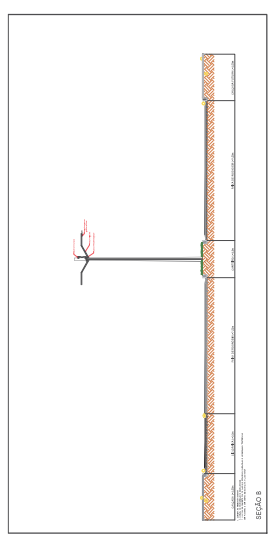

CORTE B - DET. VIA

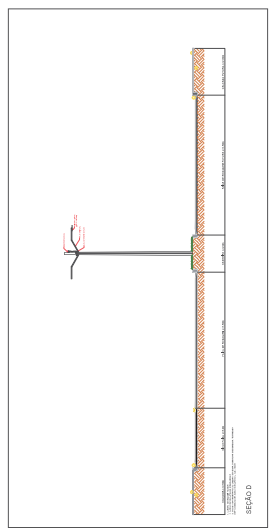

CORTE D - DET. VIA

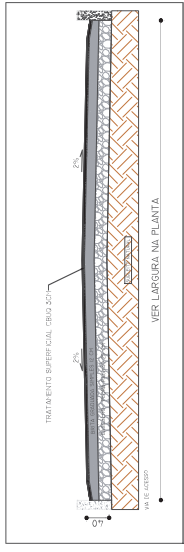

PERFIL DA PAVIMENTAÇÃO

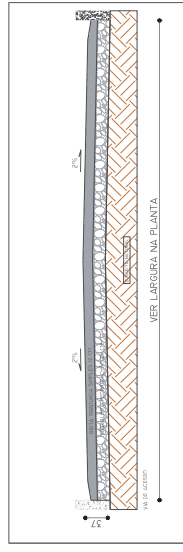

PERFIL DO ESTACIONAMENTO



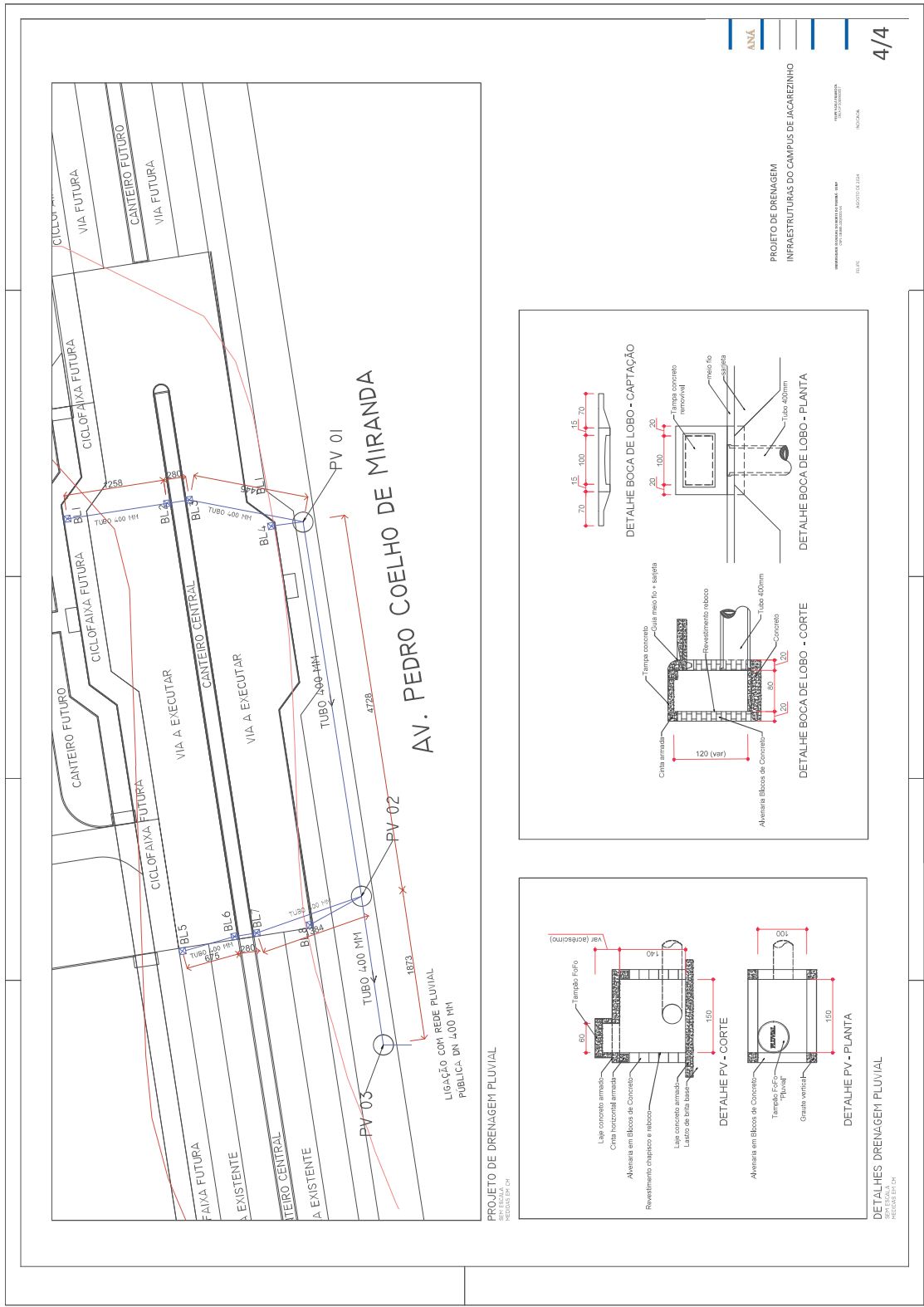

Documento: **04.PROJETO.pdf**.

Assinatura Qualificada realizada por: **Fabio Antonio Neia Martini** em 10/09/2024 14:17.

Assinatura Avançada realizada por: **Felipe Scala Francica (XXX.765.349-XX)** em 28/08/2024 11:15 Local: UENP/RTA/PROPAV.

Inserido ao protocolo **22.669.563-0** por: **Leticia Sacoman Sampaio** em: 28/08/2024 10:57.



Documento assinado nos termos do Art. 38 do Decreto Estadual nº 7304/2021.

A autenticidade deste documento pode ser validada no endereço:

<https://www.eprotocolo.pr.gov.br/spiweb/validarDocumento> com o código:

**a136dc71630cafa678111642363cb75e.**